



The heart of
your water system

Date:	June 1, 2006
Section: 9	Page: 1
Cancel & replace:	03-01-2001

WG / WGS

HIGH PRESSURE BOOSTER PUMPS



This type of pump is ideal for pressure up to 320 P.S.I. (**2200 kPa**) and when boosting is necessary. In addition to its efficiency, the pump is designed to be portable and easy to install.

APPLICATIONS

The WG/WGS high pressure booster pumps are recommended for multiple uses and locations:

- Home
- Farm
- Service station
- Maple grove
- Restaurant
- Marina
- Golf course
- Reverse osmosis
- Sprinkling system
- Spraying for high pressure cleaning* system

***NOTE:** When used for cleaning purposes, pressure and capacity vary according to the size of the hose.

FEATURES

Discharge head

and Motor bracket: Stainless steel casting
Suction of 1 ¼" NPT
Discharge of 1 ¼" NPT

Shaft: of stainless steel (303)

Impellers: of Polycarbonate

Diffusers: of Noryl

Discs "WG" series: of Acetal

Discs "WGS" series: of Stainless steel

? Capacity from 5 to 27 gallons / minute
(19 to 76 liters / minute)

? Maximum pressure of 320 P.S.I. (**2200 kPa**)

? Maximum temperature 80° F (**27° C**)

? Rotation: **clockwise**

MOTOR

- Open motor (ODP), "**J-face**" flange or, in option, a close motor (TEFC)
- 1/2 H.P. to 2.0 H.P., 115/230 Volts - 1 Phase - 60 Hz
- 3.0 H.P., 230 Volts - 1 Phase - 60 Hz
- Capacitor start
- Double bearing ball and automatic thermal protection



To avoid creating a VACUUM with the WG / WGS high pressure booster pumps intake, we recommend the use of a vacuum breaker.



The heart of
your water system



Date:	June 1, 2006
Section: 9	Page: 2
Cancel & replace:	03-01-2001

WG / WGS

HIGH PRESSURE BOOSTER PUMP

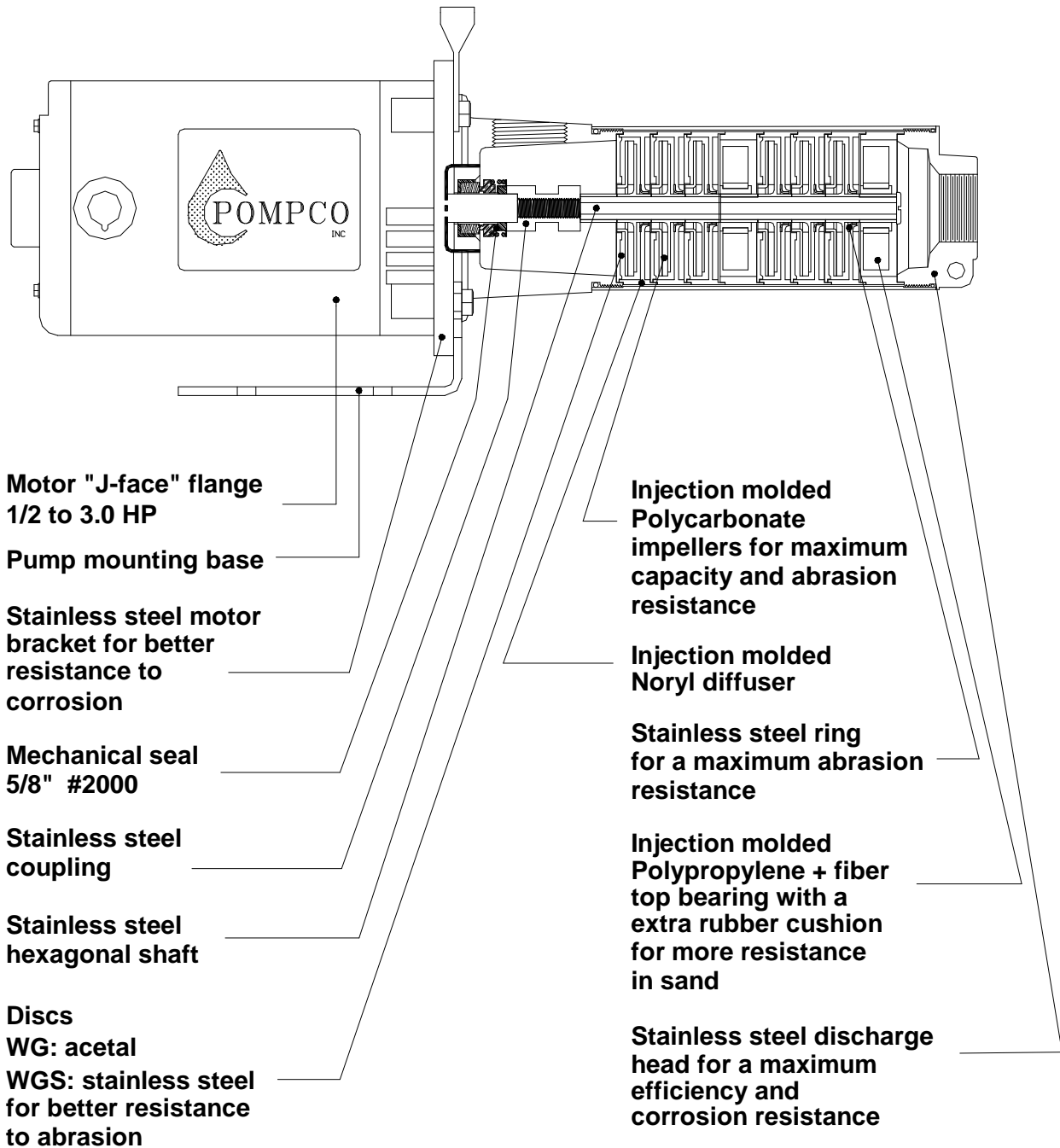



The heart of
your water system

Date:	June 1, 2006
Section: 9	Page: 3
Cancel & replace:	03-01-2001

WG/WGS HIGH PRESSURE BOOSTER PUMPS (5 - 8 - 12 - 20 G.P.M)

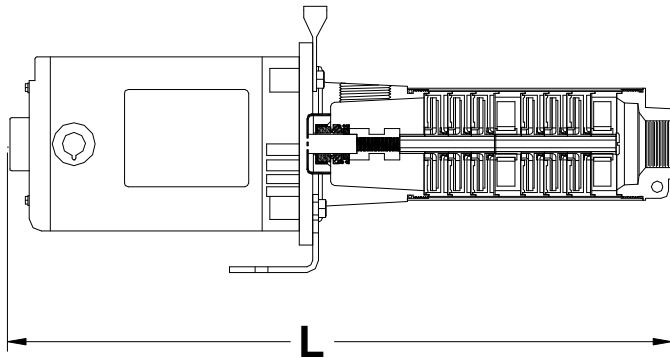

WG MODEL
(with acetal discs)

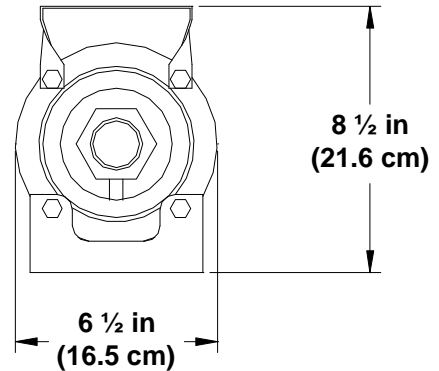

WGS MODEL
(with stainless steel discs)

H.P.	G.P.M.	Sta.	Part number	Model	Sugg. list price	Part number	Model	Sugg. list price	L inch (cm)	Shipping weight lbs (kg)
1/2	5	12	560-0010	WG5-50	799.00	560-5010	WGS-5-50	827.00	24.50 (62.2)	38 (17.2)
	8	10	560-0050	WG8-50	781.00	560-5050	WGS-8-50	805.00	23.25 (58.9)	37 (19.7)
	12	8	560-0100	WG12-50	758.00	560-5100	WGS-12-50	781.00	21.75 (55.1)	36 (16.3)
3/4	5	16	560-0020	WG5-75	894.00	560-5020	WGS-5-75	933.00	28.50 (72.4)	40 (18.1)
	8	12	560-0060	WG8-75	855.00	560-5060	WGS-8-75	889.00	25.50 (64.8)	39 (17.6)
	12	10	560-0110	WG12-75	835.00	560-5110	WGS-12-75	863.00	24.25 (61.6)	38 (17.2)
1	5	22	560-0030	WG5-100	999.00	560-5030	WGS-5-100	1 056.00	34.25 (87.0)	48 (21.7)
	8	18	560-0070	WG8-100	951.00	560-5070	WGS-8-100	995.00	30.25 (76.9)	47 (21.3)
	12	14	560-0120	WG12-100	909.00	560-5120	WGS-12-100	945.00	27.25 (69.2)	46 (20.8)
	20	10	560-0160	WG20-100	885.00	560-5160	WGS-20-100	921.00	24.25 (61.6)	45 (20.4)
1 1/2	8	20	560-0080	WG8-150	1 039.00	560-5080	WGS-8-150	1 092.00	32.50 (82.6)	53 (24.0)
	12	17	560-0130	WG12-150	998.00	560-5130	WGS-12-150	1 038.00	29.50 (74.9)	52 (23.5)
	20	13	560-0170	WG20-150	975.00	560-5170	WGS-20-150	1 006.00	29.75 (75.6)	51 (23.1)
2	12	19	560-0140	WG12-200	1 100.00	560-5140	WGS-12-200	1 150.00	31.75 (80.7)	62 (28.1)
	20	15	560-0180	WG20-200	1 080.00	560-5180	WGS-20-200	1 118.00	32.50 (82.6)	61 (27.6)
3	12	26	560-0150	WG12-300	1 490.00	560-5150	WGS12-300	1 551.00	39.25 (99.7)	63 (28.5)
	20	20	560-0190	WG20-300	1 449.00	560-5190	WGS-20-300	1 498.00	39.75 (100)	65 (29.4)

PUMP:

- Stainless steel pump head and motor bracket
- Suction and discharge 1 1/4" NPT

MOTOR:

- Motor 1/2 H.P. to 2 H.P. - 115/230 Volts - 1 Phase
- Motor 3 H.P. - 230 Volts - 1 Phase
- **Other voltage available in options**

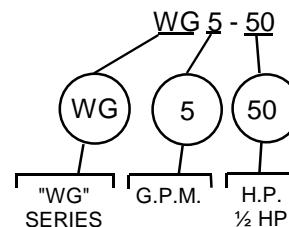



The heart of
your water system

Date:	June 1, 2006
Section: 9	Page: 4
Cancel & replace:	03-01-2001

WG/WGS HIGH PRESSURE PUMPS + ADAPTER (5 - 8 - 12 - 20 G.P.M) can receive a pulley or direct coupling



WG MODEL
(with acetal discs)

WGS MODEL
(with stainless steel discs)

H.P.	G.P.M.	Stages	Part #	Model	List price	Part #	Model	List price
1/2	5	12	560-0011	WG5-50 + adapt.	916.00	560-5011	WGS-5-50 + adapt.	947.00
	8	10	560-0051	WG8-50 + adapt.	907.00	560-5051	WGS-8-50 + adapt.	936.00
	12	8	560-0101	WG12-50 + adapt.	907.00	560-5101	WGS-12-50 + adapt.	931.00
3/4	5	16	560-0021	WG5-75 + adapt.	967.00	560-5021	WGS-5-75 + adapt.	1 009.00
	8	12	560-0061	WG8-75 + adapt.	928.00	560-5061	WGS-8-75 + adapt.	962.00
	12	10	560-0111	WG12-75 + adapt.	925.00	560-5111	WGS-12-75 + adapt.	950.00
1	5	22	560-0031	WG5-100 + adapt.	1 060.00	560-5031	WGS-5-100 + adapt.	1 118.00
	8	18	560-0071	WG8-100 + adapt.	1 042.00	560-5071	WGS-8-100 + adapt.	1 090.00
	12	14	560-0121	WG12-100 + adapt.	972.00	560-5121	WGS-12-100 + adapt.	1 007.00
	20	10	560-0161	WG20-100 + adapt.	976.00	560-5161	WGS-20-100 + adapt.	978.00
1 1/2	8	20	560-0081	WG8-150 + adapt.	1 059.00	560-5081	WGS-8-150 + adapt.	1 328.00
	12	17	560-0131	WG12-150 + adapt.	1 009.00	560-5131	WGS-12-150 + adapt.	1 060.00
	20	13	560-0171	WG20-150 + adapt.	998.00	560-5171	WGS-20-150 + adapt.	1 032.00
2	12	19	560-0141	WG12-200 + adapt.	1 118.00	560-5141	WGS-12-200 + adapt.	1 172.00
	20	15	560-0181	WG20-200 + adapt.	1 018.00	560-5181	WGS-20-200 + adapt.	1 062.00
3	12	26	560-0151	WG12-300 + adapt.	1 176.00	560-5151	WGS12-300 + adapt.	1 253.00
	20	20	560-0191	WG20-300 + adapt.	1 124.00	560-5191	WGS-20-300 + adapt.	1 175.00

PUMP:

- Stainless steel pump head and motor bracket
- Suction and discharge 1 1/4" NPT

ADAPTER:

- Cast iron

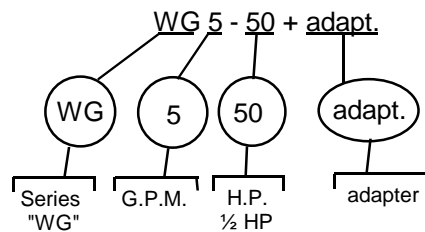



The heart of
your water system

Date:	June 1, 2006
Section: 9	Page: 5
Cancel & replace:	03-01-2001

PUMPING CHART WG / WGS 5 G.P.M.

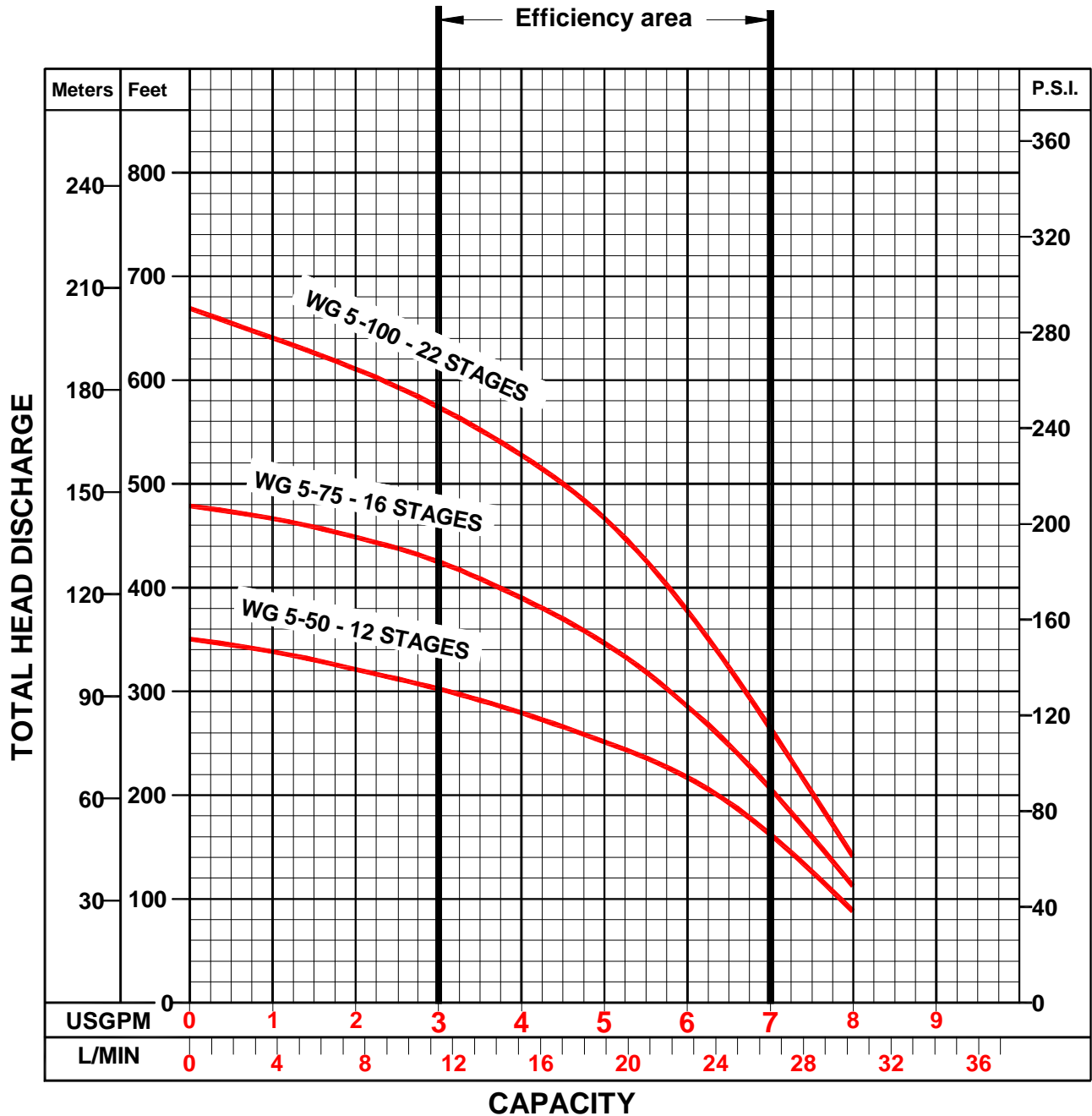



The heart of
your water system

Date:	June 1, 2006
Section: 9	Page: 6
Cancel & replace:	03-01-2001

PUMPING CHART WG / WGS 8 G.P.M.

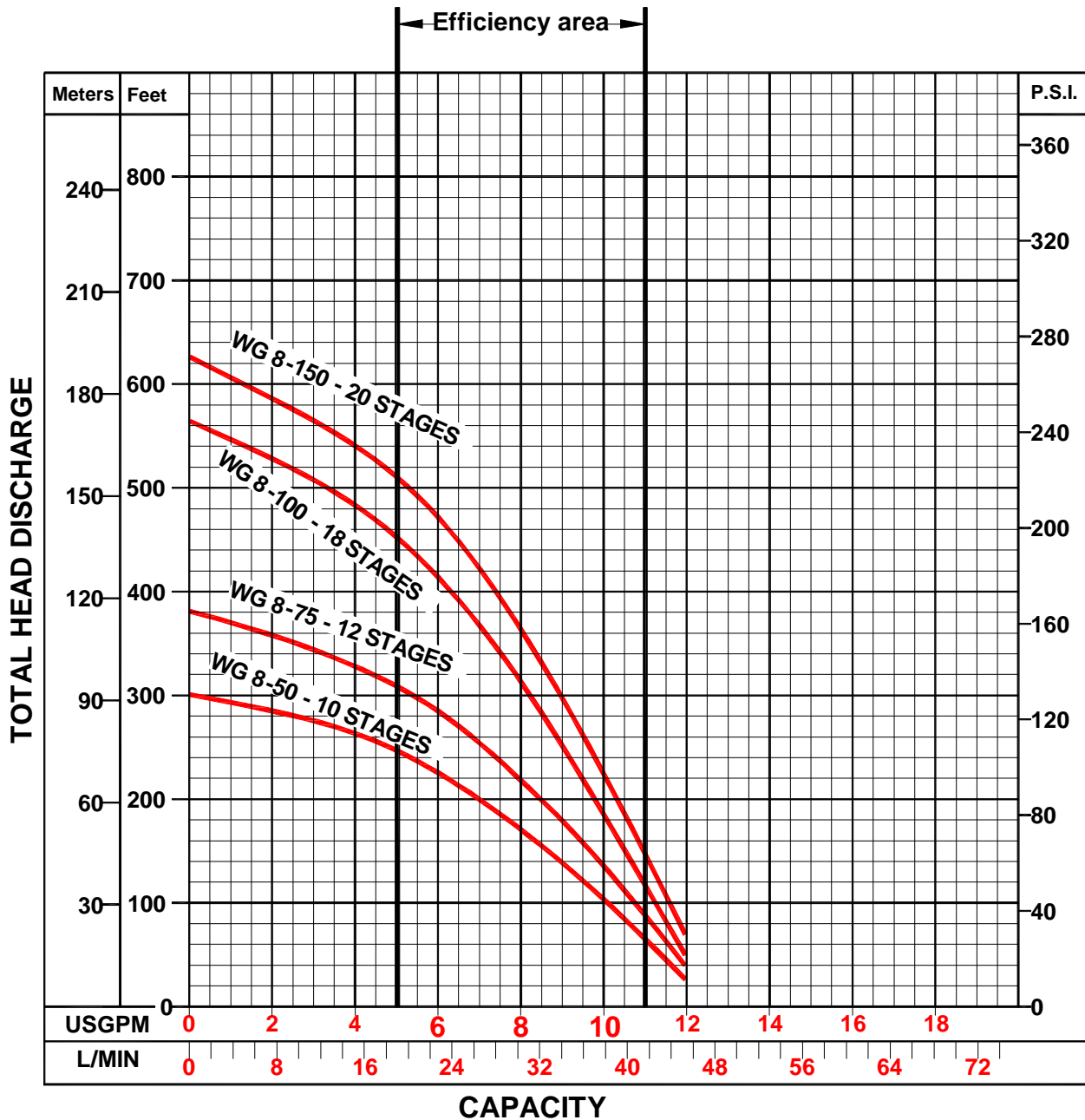



The heart of
your water system

Date:	June 1, 2006
Section: 9	Page: 7
Cancel & replace:	03-01-2001

PUMPING CHART WG / WGS 12 G.P.M.

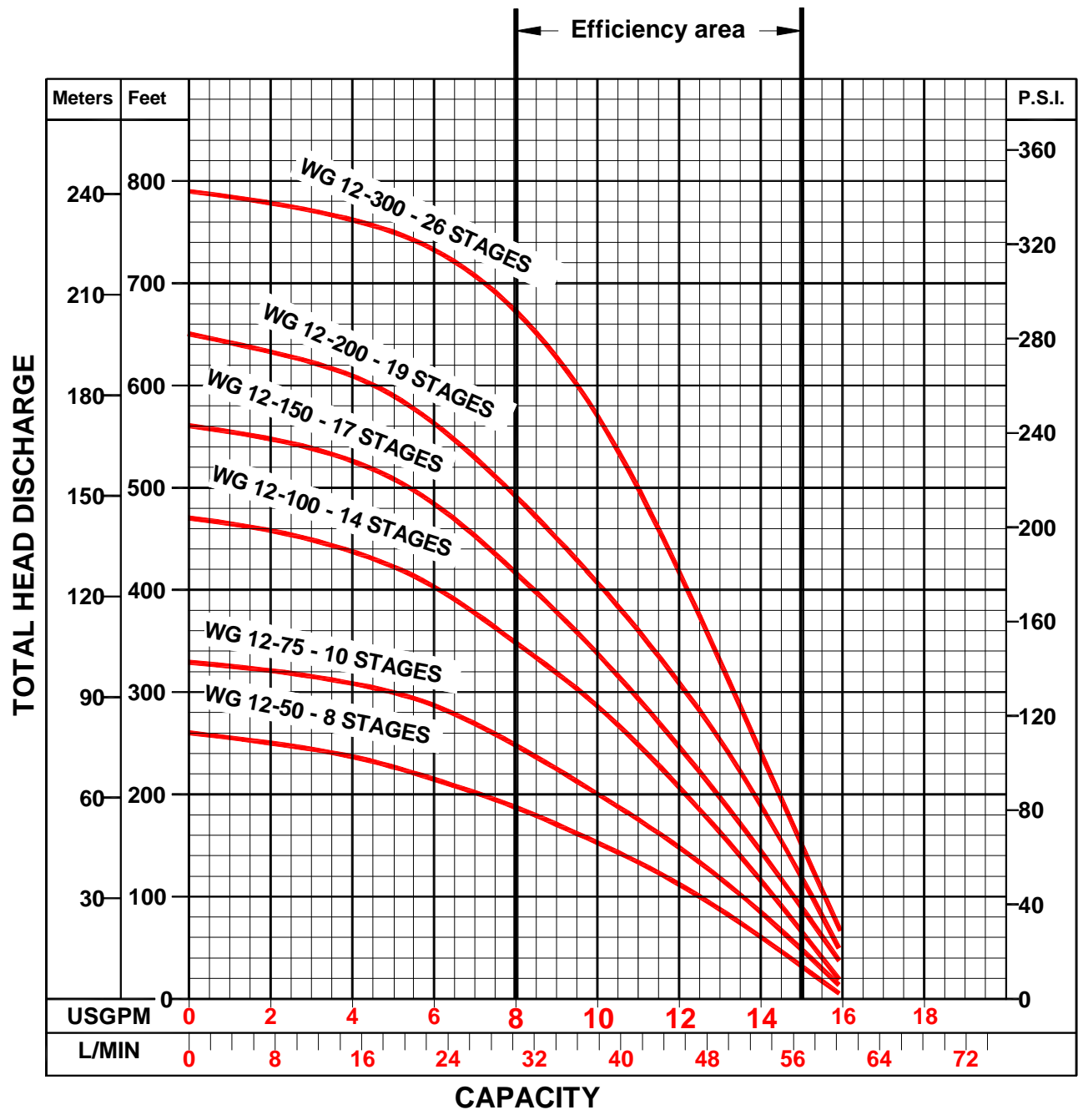



The heart of
your water system

Date:	June 1, 2006
Section: 9	Page: 8
Cancel & replace:	03-01-2001

PUMPING CHART WG / WGS 20 G.P.M.

