

Model 007-IFC® Cartridge Circulator

The redesigned 007-IFC features a larger, removable Integral Flow Check designed to improve pump performance, simplify piping and reduce installation costs. The spring-loaded IFC replaces a separate in-line-flow check to ensure protection against reverse flow and gravity flow. IFC is available on all 00® Circulators including Priority Zoning and Variable Speed control models.



HYDRONIC COMPONENTS & SYSTEMS

Do it once.
Do it right.® **Taco**

Submittal Data Information Model 007-IFC® Cartridge Circulator

Features

- Integral Flow Check (IFC®)
 - Simplifies piping
 - Prevents reverse flow and gravity flow
 - Eliminates separate in-line flow check
 - Reduces installed cost
 - Improves system performance
 - Easy to service
- Unique replaceable cartridge-field serviceable
- Unmatched reliability-maintenance free
- Quiet, efficient operation
- Self lubricating, No mechanical seal
- Wide range of applications
- Cast Iron or Bronze construction, Flanged connections

Application

- Hydronic Heating/Cooling
- Radiant
- Indirect Water Heaters
- Hydro-Air Fan Coils
- Domestic Water Recirculation (Bronze only)

The 007-IFC is designed to simplify piping, reduce installation costs and improve system performance when zoning with "00" circulators. By locating the IFC inside the pump, a separate in-line flow check is eliminated. The low pressure drop of the IFC increases flow performance vs. in-line flow checks. Both the IFC and the cartridge are easily accessed for removal and service.

Pump Dimensions & Weights

Model	Casing	A		B		C		D		E		F		Ship Wt.	
		in.	mm	in.	mm	in.	mm	in.	mm	in.	mm	in.	mm	lbs.	kg
007-F5-7 IFC	Cast Iron	6-1/8	156	4-1/2	114	3-3/16	81	2-15/16	75	5	127	6-3/8	162	9	4.0
007-F5-8 IFC	Cast Iron	5-7/8	149	4-1/2	114	3-3/16	81	2-15/16	75	5	127	6-3/8	162	9	4.0
007-BF5-1 IFC	Bronze	6-1/8	156	4-1/2	114	3-3/16	81	2-15/16	75	5	127	6-3/8	162	9	4.0

Materials of Construction

- Casing (Volute): Cast Iron or Bronze
- Integral Flow Check (IFC®):
- Body, Plunger Acetal
 - O-ring Seals EPDM
 - Spring Stainless Steel
- Stator Housing: Steel
- Cartridge: Stainless Steel
- Impeller: Non-Metallic
- Shaft: Ceramic
- Bearings: Carbon
- O-Ring & Gaskets: EPDM

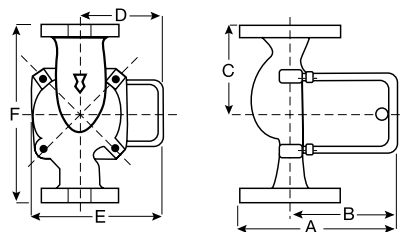

Mounting Positions

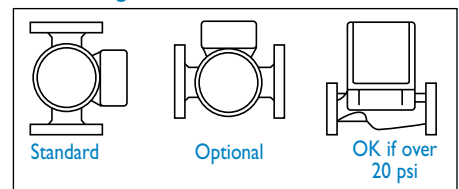

Electrical Data

Model	Volts	Hz	Ph	Amps	RPM	HP
Cast Iron	115	60	1	.71	3250	1/25
Bronze	115	60	1	.76	3250	1/25
Motor Type	Permanent Split Capacitor Impedance Protected					
Motor Options	220/50/1, 220/60/1, 230/60/1, 100/110/50/60/1					

Flange Orientation

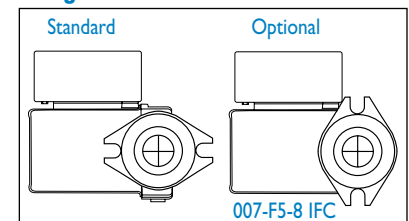

Model Nomenclature

- F – Cast Iron, Flanged
- BF – Bronze, Flanged
- IFC® – Integral Flow Check

Variations:

- Z – Zoning Circulator
- VR – Variable Speed Outdoor Reset
- VS – Variable Speed Set Point
- VV – Variable Speed Variable Voltage
- J – Bronze Cartridge with Cast Iron Casing

Performance Data

- Flow Range: 0 - 17 GPM
- Head Range: 0 - 8.5 Feet
- Minimum Fluid Temperature: 40°F (4°C)
- Maximum Fluid Temperature: 230°F (110°C)
- Maximum Working Pressure: 125 psi
- Connection Sizes: 3/4", 1", 1-1/4", 1-1/2" Flanged



FOR INDOOR USE ONLY

Performance Field - 60Hz

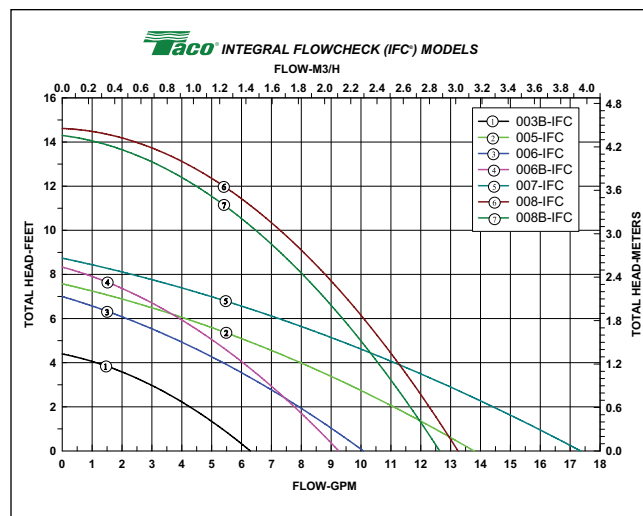

HYDRONIC COMPONENTS & SYSTEMS

