

## Model 0011-IFC® Cartridge Circulator

The High Velocity series 0011-IFC includes an Integral Flow Check, saving installation costs while improving system performance. The removable, spring loaded IFC® replaces a separate in-line flow check and prevents gravity flow when the circulator is not operating. Our Priority Zoning circulator with built-in transformer relay, and priority switch is also available with an optional IFC to make it an ideal choice when zoning with circulators. Available in Cast Iron, Bronze or Stainless Steel construction.



# Submittal Data Information

## Model 0011-IFC® Cartridge Circulator

Submittal Data # 101-084  
Supersedes: 12/01/03

Effective: 06/27/07

### Features

- Integral Flow Check (IFC®)
  - Prevents gravity flow
  - Eliminates separate in-line flow check
  - Reduces installed cost, easy to service
  - Improved performance vs. In-line flow checks
- Unique replaceable cartridge-Field serviceable
- Unmatched reliability-Maintenance free
- Quiet, efficient operation
- Direct drive-Low power consumption
- Self lubricating, No mechanical seal
- Standard high capacity output-Compact design
- Wide range of applications
- Cast Iron, Bronze or Stainless Steel construction, Flanged connections

### Materials of Construction

Casing (Volute): Cast Iron, Bronze or 304 Stainless Steel  
 Integral Flow Check:  
 Body, Plunger....Acetal  
 O-ring Seals.....EPDM  
 Spring.....Stainless Steel  
 Stator Housing: Aluminum  
 Cartridge: Stainless Steel  
 Impeller: Non-Metallic  
 Shaft: Ceramic  
 Bearings: Carbon  
 O-Ring & Gaskets: EPDM

### Model Nomenclature

F – Cast Iron, Flanged  
 BF – Bronze, Flanged  
 SF – 304 Stainless Steel, Flanged  
 IFC – Integral Flow Check

### Variations:

Z – Zoning Circulator  
 J – Bronze Cartridge with Cast Iron Casing

### Performance Data

Flow Range: 0 - 30 GPM  
 Head Range: 0 - 31 Feet  
 Minimum Fluid Temperature: 40°F (4°C)  
 Maximum Fluid Temperature: 230°F (110°C)  
 Maximum Working Pressure: 125 psi  
 Connection Sizes: 3/4", 1", 1-1/4", 1-1/2" Flanged



FOR INDOOR USE ONLY

### Application

The 0011-IFC with an Integral Flow Check is designed to reduce installation costs when zoning with 00® circulators on large residential / light commercial high head / medium flow applications such as hydronic or radiant heating, hydro-air fan coils, indirect water heaters or domestic water recirculation systems. By locating the removable, spring-loaded IFC inside the pump casing, a separate in-line flow check is eliminated, reducing installation costs. The reduced pressure drop of the IFC increases the 0011 flow performance over in-line check valves. Both the IFC and cartridge are easily accessed for service instead of replacing the entire unit. Our patented Priority Zoning circulator with built-in transformer, relay, priority switch and IFC in one complete, compact package to make it ideal for zoning.

Model	Casing	A		B		C		D		F		G		Ship Wt.	
		in.	mm	in.	mm	in.	mm	in.	mm	in.	mm	in.	mm	lbs.	Kg
0011-F4-2 IFC	Iron	7-1/2	191	6-1/8	156	3-1/2	89	3-5/16	84	5-1/2	140	6-1/2	165	12	5.5
0011-BF4-4 IFC	Bronze														
0011-SF4-IFC	St. Steel														
0011-ZF4-1 IFC	Iron														
0011-ZBF4-1 IFC	Bronze	3-13/16	97	6	152									13	6.0
0011-ZSF4-IFC	St. Steel														

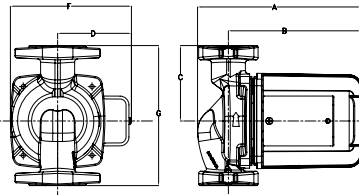

### Mounting Positions

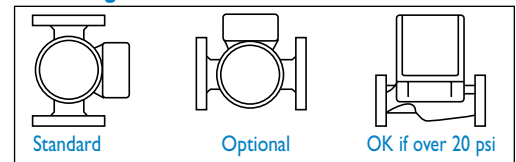

### Electrical Data

Model	Volts	Hz	Ph	Amps	RPM	HP
All Models	115	60	1	1.76	3250	1/8
Motor Type	Permanent Split Capacitor Impedance Protected					
Motor Options	220/50/1, 220/60/1, 230/60/1, 100/110/50/60/1					

### Flange Orientation

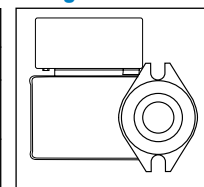

### Performance Field - 60Hz

Taco INTEGRAL FLOWCHECK (IFC) MODELS

