



Meet the new members of our circulator family. They're

just your speed.

Three speeds.



One reputation.

If you've been waiting for Taco reliability in a 3-speed circulator, wait no more. Our new Radiant and Service 3-speed pumps are built to the exacting standards you've come to expect from Taco

The 00R 3-Speed Radiant Pump. Heavy Duty Reliability.

Everything that goes into the new 3-Speed Radiant Pump- from the powerful, high performance motor to the durable 3-speed switch - says "heavy duty". With the highest starting torque in its class, this circulator delivers the performance and fine tuning capabilities sure to satisfy the most demanding radiant installer.

The 0010 3-Speed Service Pump. A perfect fit.

The 3-Speed Service Pump is specially designed to make short work of service calls. Since it replaces the most commonly used circulators you'll appreciate it the next time you're out on a job at 2 AM. The handy new **universal 4-bolt flange** simplifies change-out of any pump, regardless of style, type, or age. Keep one in the truck - just in case!

Performance Plus Convenience.

Both 3-speed circulators feature a new, extra large Integral Flow Check (IFC®) that maximizes flow, as well as a custom

high tension spring to prevent gravity flow, even in the tallest buildings. Wiring is a snap thanks to an extra roomy capacitor box and convenient dual electrical knock-outs.

Try one on for size.

Whether you need a single speed "00"®, a 3-Speed Radiant Pump for easy fine-tuning, or a 3-Speed Service Pump for convenience, you can be sure that every Taco circulator is designed to build your business. To find out more, visit www.taco-hvac.com or stop by your wholesaler for a first-hand look. You'll find we're just your speed.



**Taco**[®]
comfort made easy

www.taco-hvac.com

Submittal Data Information 3-Speed Cartridge Circulators

Catalog # 100-51
Submittal Data # 101-125
Supersedes: New

Effective: 04/26/07

Features

- 3-Speed Switch
- Fine tune to system requirements
- Highest performance & starting torque in class
- Heavy duty construction for longer life
- 4-bolt universal flange (0010 only)
- Removable high-flow Integral Flow Check (IFC®)
 - Prevents gravity flow
 - Reduces installation costs
 - Improves pump performance
- Replaceable cartridge design
- Quiet, efficient operation
- Self lubricating, no mechanical seal
- Wide range of applications
- Cast Iron, flanged construction

Materials of Construction

Casing: Cast Iron
Integral Flow Check (IFC®):
Body, Plunger.....Acetal or Noryl®
O-ring Seal.....EPDM
Spring.....Stainless Steel
Stator Housing: Steel
Cartridge: Stainless Steel
Impeller: Non-Metallic
Shaft: Ceramic
Bearings: Carbon
O-Ring & Gaskets: EPDM

Model Nomenclature

F – Cast Iron, Flanged
MS – 3-Speed Switch
IFC – Integral Flow Check

Performance Data

	00R	0010
Flow Range (GPM):	0-18	0-29
Head Range (FT):	0-21	0-10.5
Minimum Fluid Temperature:	40°F (4°C)	
Maximum Fluid Temperature:	230°F (110°C)	
Maximum Working Pressure:	125 psi	
Connection Sizes:	3/4", 1", 1-1/4", 1-1/2" Flanged	



FOR INDOOR USE ONLY

Noryl is a trademark of General Electric Company

Application

The **00R 3-Speed Radiant pump** is specifically designed for the flow and head requirements of today's radiant heat systems. Its' 3-Speed switching capability provides fine tuning control to match a wide combination of tube diameters and length of runs. The 00R 3-Speed Radiant pump is a direct replacement for the Grundfos UPS 15-58 3-Speed. The 00R delivers the highest starting torque in its class and a removable, high-flow Integral Flow Check (IFC®) that prevents gravity flow, reduces installation costs and improves pump performance.

The **0010 3-Speed Service pump** is designed as an ideal replacement circulator for service contractors to use on any emergency "no-heat" call. The 0010 3-Speed replaces most commonly used circulators. Simply install it and set the speed to match the original pump performance. The handy new four bolt flange matches up to any pump regardless of style, type or age.

Pump Dimensions & Weights

	A		B		C		D		F		G		Ship Wt.	
	in.	mm	in.	mm	in.	mm	in.	mm	in.	mm	in.	mm	lbs.	Kg
Cast Iron Models														
00R-MSFI-IFC	6-1/2	165	4-5/8	118	3-3/16	81	3-7/16	87	5-3/8	137	6-3/8	162	9	4.0
00R-MSFI-I IFC	6	152	4-5/8	118	3-3/16	81	3-7/16	87	5-3/8	137	6-3/8	162	9	4.0
0010-MSFI-IFC	6-11/16	170	4-3/4	120	3-3/16	81	3-7/16	87	5-1/2	140	6-3/8	162	10	4.5

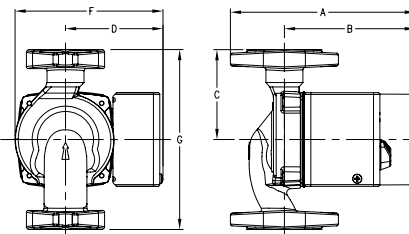

Mounting Positions

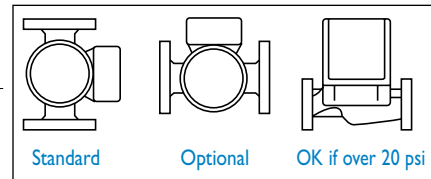

Electrical Data

Model	Volts	Hz	Ph	Amps			RPM	HP
				Speed 1	Speed 2	Speed 3		
All Models	115	60	1	.75	.91	1.10	3250	1/20
Motor Type	Permanent Split Capacitor Thermally Protected							

Flange Orientation

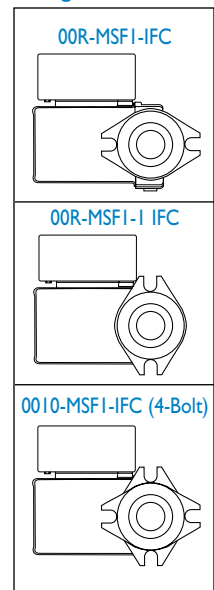

Performance Field - 60Hz

